

LINE	BEARING	DISTANCE
L1	S 87°28'32" E	15.83'
L2	S 87°28'32" E	15.11'
L3	N 87°26'44" W	25.89'
L4	N 87°26'44" W	27.81'
L5	S 04°26'01" E	38.03'
L6	S 12°58'23" W	62.12'
L7	S 26°24'02" W	94.45'
L8	S 57°06'56" W	77.22'
L9	S 50°48'35" W	81.83'
L10	S 59°54'57" W	14.14'

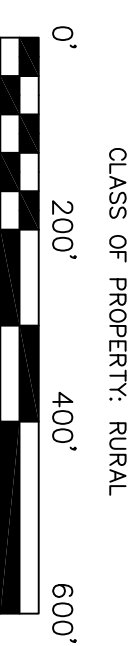

CURVE	ARC LENGTH	RADIUS	CHORD BEARING	CHORD LENGTH
C1	50.39'	94.00'	S 41°45'29" W	49.79'

**PROPERTY DESCRIPTION**

SHADY RIDGE PARCEL 41: All that part of the South Half of the Northeast Quarter of the Northwest Quarter of the Southwest Quarter lying north and west of the centerline of the access road thereon in Section 10, township 28 North Range 9 West.

SHADY RIDGE PARCEL 44: All that part of the South Half of the Northeast Quarter of the Northwest Quarter of the Southwest Quarter lying east of the centerline of the access road thereon in Section 10, Township 28 North, Range 9 West.

**LEGEND**

- These standard symbols will be found in the drawing:
- X—X— FENCE LINE
  - T.C.S.R. TEXAS COUNTY SURVEY RECORD
  - SET 1/2" REBAR
  - ▲ FOUND SET STONE
  - ⊙ FOUND IRON PIN

I, LOUIE E. CARMACK JR., TEXAS COUNTY SURVEYOR, MISSOURI REGISTERED LAND SURVEYOR, NO. 2290, DECLARE THAT THE SURVEY SHOWN ON THIS PLAT WAS MADE BY ME OR UNDER MY DIRECTION, AND IS TO THE CURRENT MINIMUM STANDARDS FOR PROPERTY BOUNDARY SURVEYS.  
 C. OF A. NO. 2009021547.  
 DATE FIELD WORK COMPLETED: 10/8/2010  
 LOUIE E. CARMACK JR.

CARMACK SURVEYING, INC.  
 12071 HWY. 32  
 ROBY, MO. 65557  
 PH: 417-458-4798

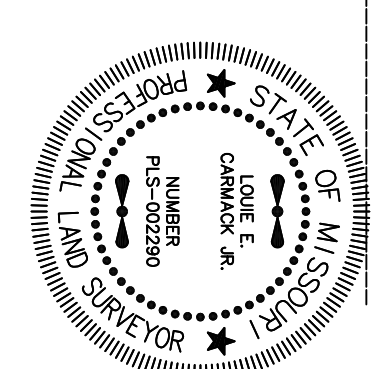

THIS SURVEY IS RECORDED IN T.C.S.R. BOOK 18, PAGE 110.

**SURVEY FOR  
 OZARK LAND COMPANY**

DRAWN	DATE	TEXAS COUNTY, MO.
RLS	10/11/10	SEC. 10
APPROVED	DATE	T28N, R9W
LBC	10/11/10	PROJECT NO.
SCALE	SHEET	C-7188
1" = 200'	1 OF 1	